



# Model 22HHP

## Hybrid (bushingmount servomount) Low cost item

### Standard dimensions (with metric dimensions)

#### Bushingmount type

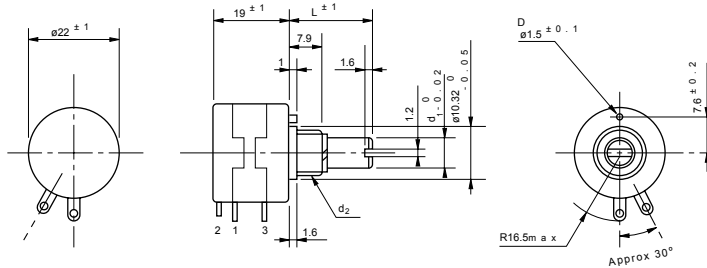

Note: Dimensions of shaft and bushing are equal to those of model 22HP series with wirewound resistive element and please refer to those dimensions and notes



**Model 22HHP-10  
(Bushingmount)**

#### Servomount type (bronze bearing incorporated)

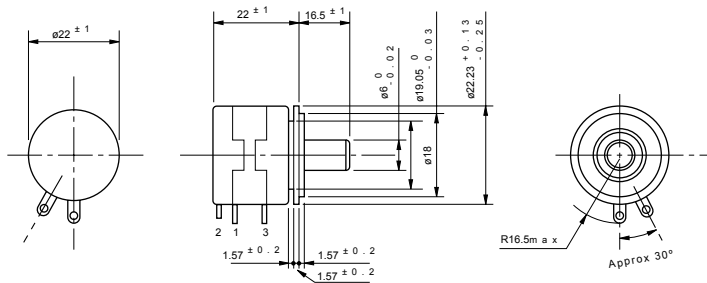

**Model 22HHP-10  
(Servomount)**

### Standard Model Nos.

#### Bushingmount type:

5-turn models:	22HHP-5	22HHP-5M
	22HHP-5E	22HHP-5N
10-turn models:	22HHP-10	22HHP-10M
	22HHP-10E	22HHP-10N

#### Servomount type:

5-turn models:	22HHPS-5
10-turn models:	22HHPS-10

### General Specifications

#### Standard Resistance

**Values:** 1k, 2k, 5k, 10k, 20k, 50k ( $\Omega$ ) (5-turn)  
 2k, 5k, 10k, 20k, 50k, 100k ( $\Omega$ ) (10-turn)

#### Total Resistance

**Tolerance:** Standard Class  $\pm 10\%$ (K)  
 Precision Class  $\pm 5\%$ (J)

#### Independent Linearity

**Tolerance:**

	5-turn	10-turn
Standard Class	$\pm 0.35\%$	$\pm 0.25\%$
Precision Class	$\pm 0.2\%$	$\pm 0.1\%$

#### Resolution:

Essentially infinite

#### Output Smoothness:

Within 0.05% against input voltage (5-turn)  
 Within 0.015% against input voltage (10-turn)

<b>Contact Resistance Variation:</b>	Within 5% C.R.V. (5-turn) Within 3% C.R.V. (10-turn)
<b>Power Rating:</b>	1.0W (5-turn) 2.0W (10-turn)
<b>Electrical Travel:</b>	360° X n ±5° (n: No. of turns)
<b>Mechanical Travel:</b>	360° X n $^{+10^{\circ}}_{0^{\circ}}$ (n: No. of turns)
<b>Insulation Resistance:</b>	Over 100MΩ at 1,000V.D.C.
<b>Dielectric Strength:</b>	1 minute at 1,000 V.A.C.
<b>Starting Torque:</b>	Within 5mN·m (50gf·cm)
<b>Stopper Strength:</b>	Approx. 0.9N·m (9kgf·cm)
<b>Max. Working Voltage:</b>	500V
<b>Resistance Temperature Coefficient:</b>	±100p.p.m./°C
<b>Max. Torque exerted on fastening the mounting nut to the bushing:</b>	Within 1.0N·m (10kgf·cm) (in case of panel thickness with over 2.5mm, the rotating torque may become heavier)
<b>Mass:</b>	Approx. 20g (Bushingmount) Approx. 30g (Servomount) (both 5-turn and 10-turn)

### ■ Special Specifications Available

Shaft with front and rear extension (rear shaft with 6mm dia. and 15mm length), 3-turn type, multi-ganged (available up to 10-gangs), with high torque, special shaft dia. (ø3mm, ø3.175mm, ø4mm, ø5mm, ø6.35mm), special machining on the shaft, with plastic shaft, metal bushing type (22HHPM with anti-rotation pin), simple sealed housing, extra taps (available up to 1 tap only for 10-turn), slipping-clutch incorporated type (20mN·m~60mN·m).

#### ALThERIS bv

Scheveningseweg 15  
2517 KS DEN HAAG  
The Netherlands

☎ +31 (0)70 3924421

☎ +31 (0)70 3644249

Offices in : Benelux | Germany | France | UK | Italy | USA

🌐 [www.altheris.com](http://www.altheris.com)

✉ [sales@altheris.nl](mailto:sales@altheris.nl)

LEADERS IN SENSORS & HEAVY DUTY JOYSTICKS

**ALThERIS**  
SENSORS & CONTROLS